

APPROX. WEIGHT  
(LBS)  
394

D

C

B

A

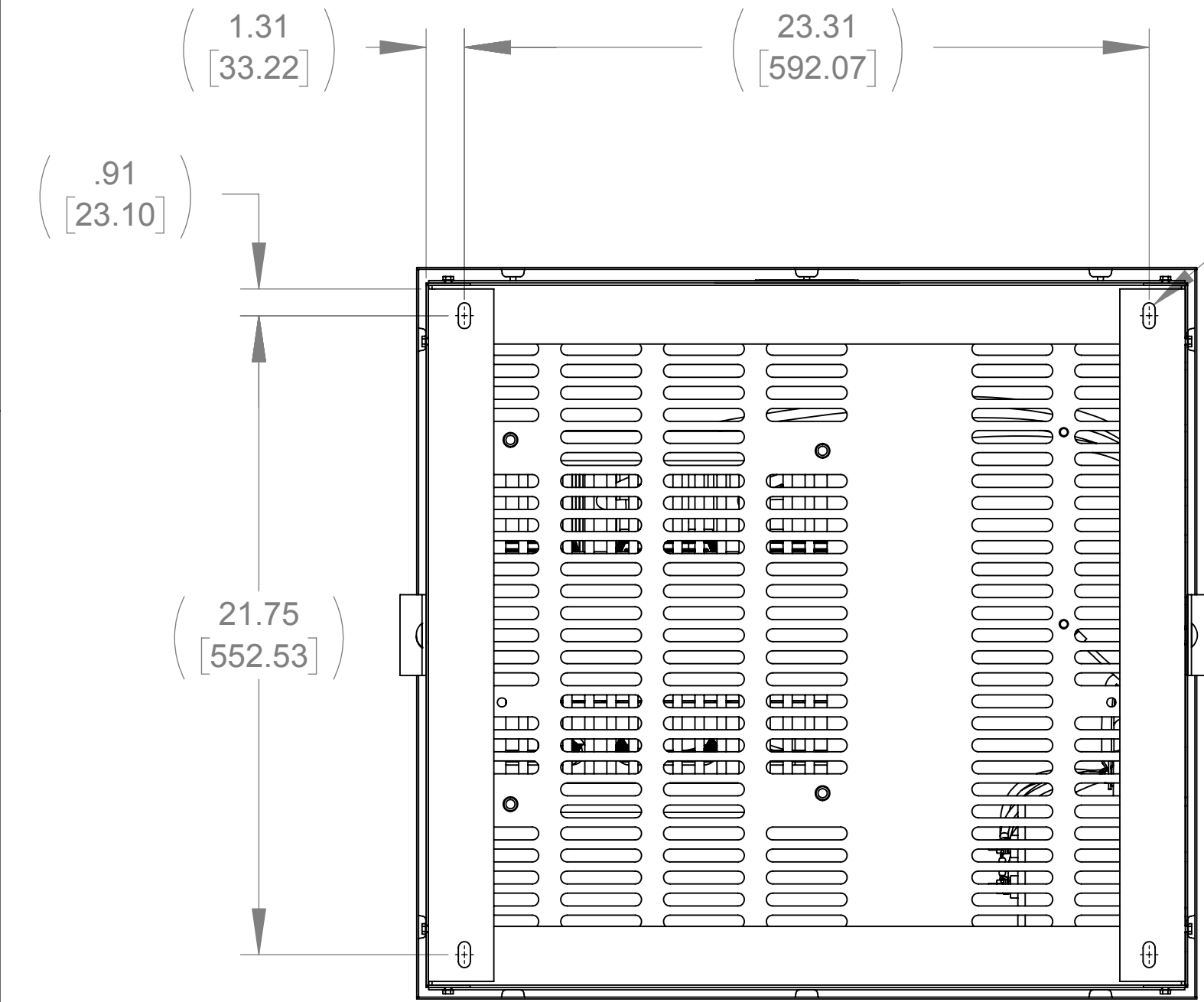
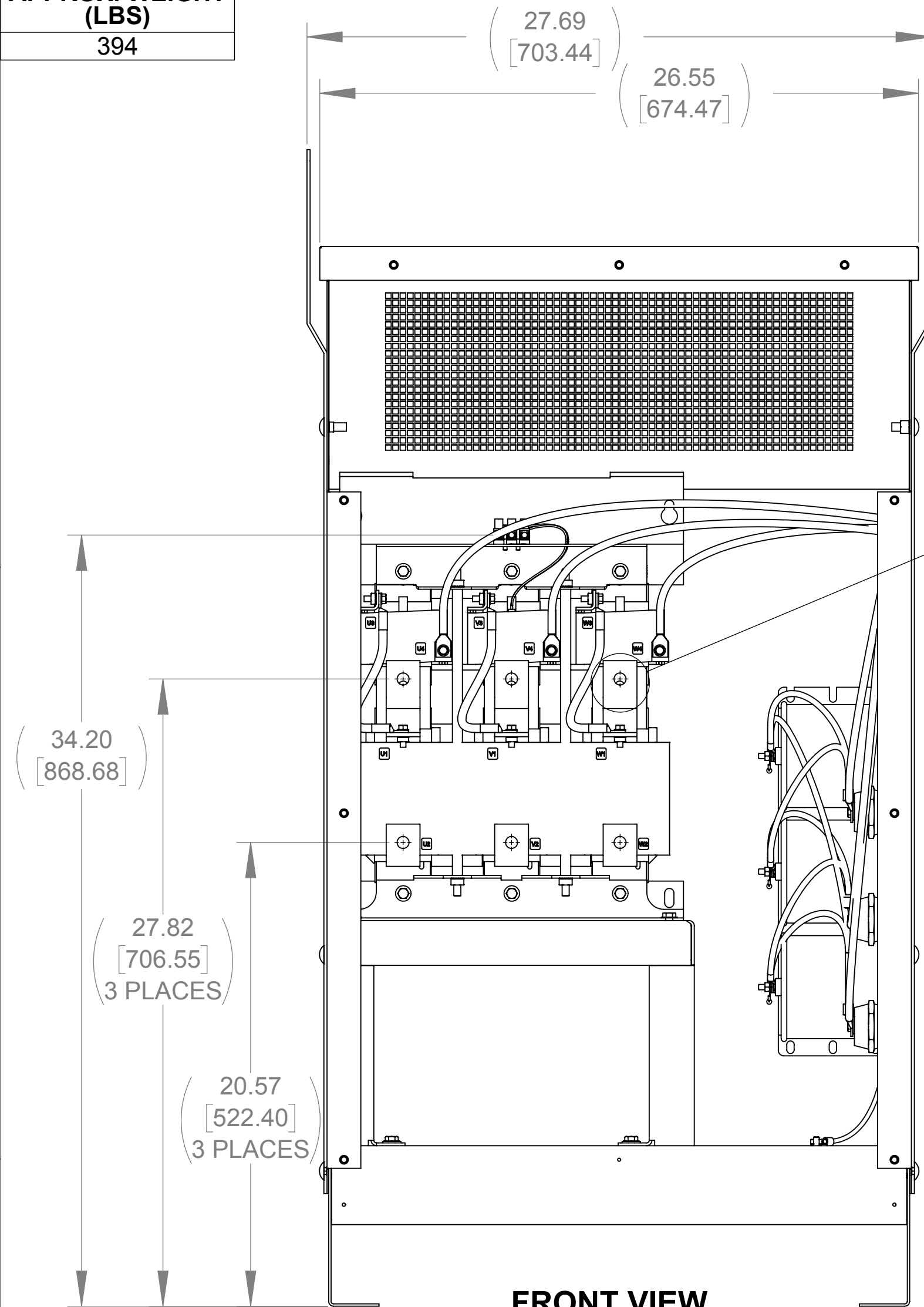

BOTTOM VIEW

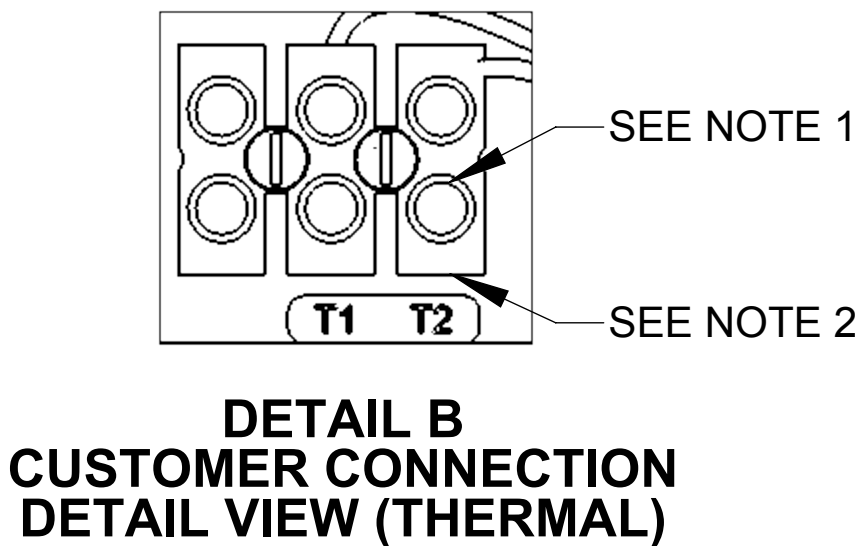
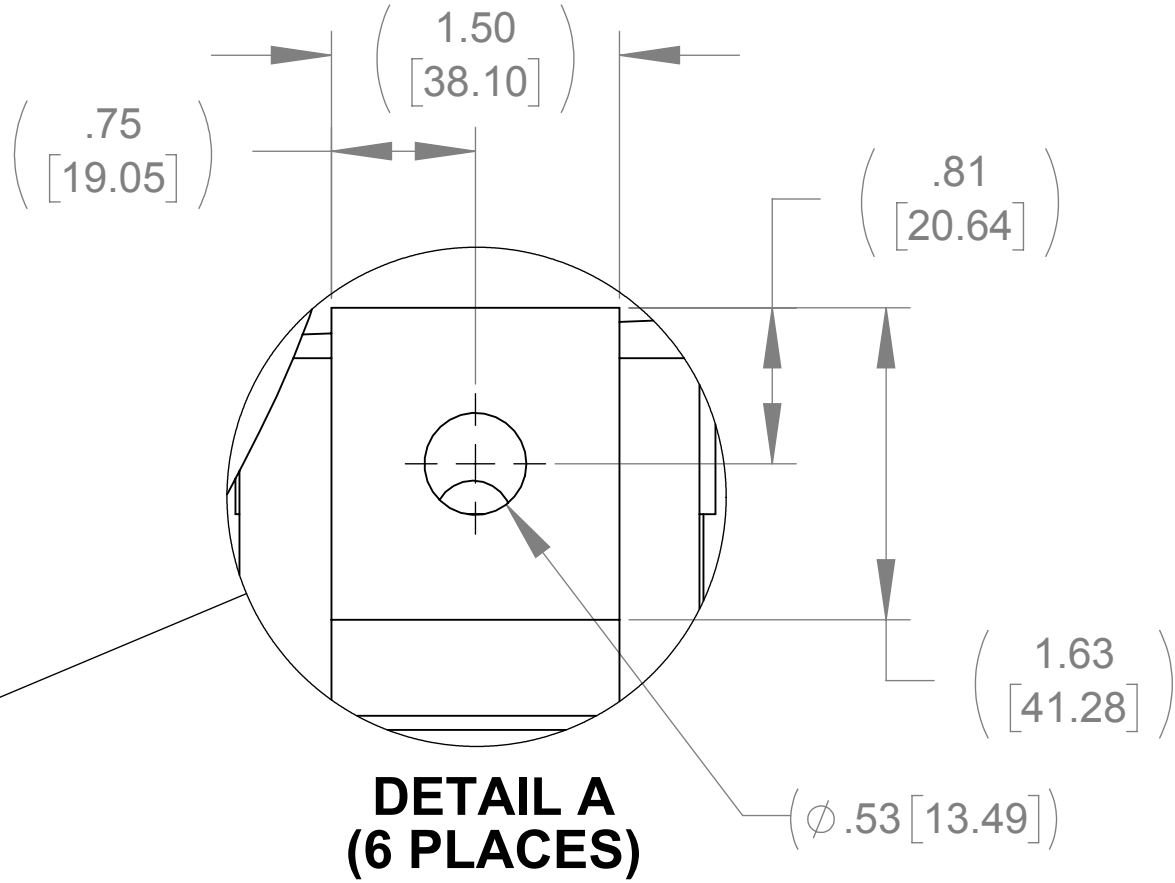

DETAIL B  
CUSTOMER CONNECTION  
DETAIL VIEW (THERMAL)

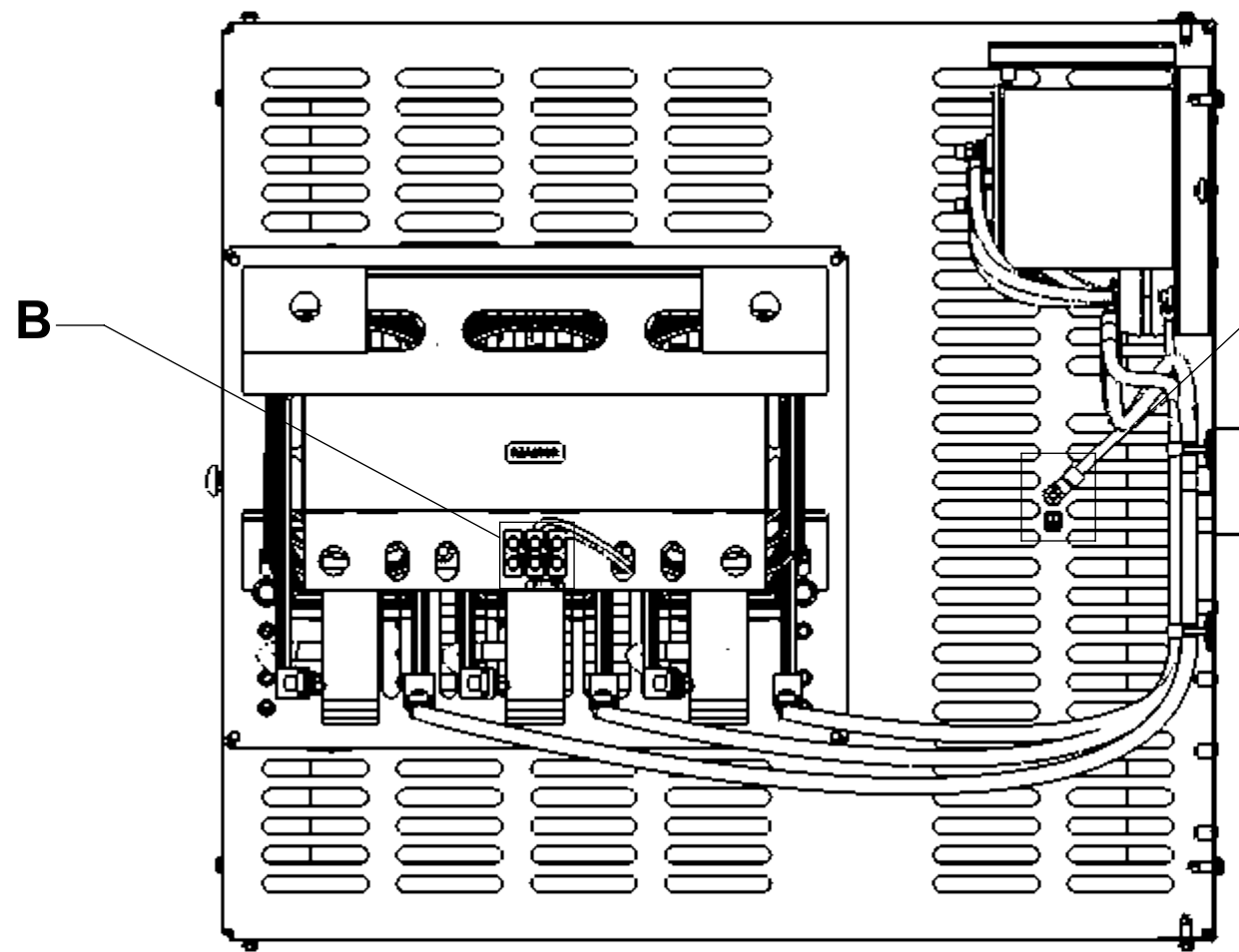

TOP VIEW  
(TOP PANEL REMOVED)

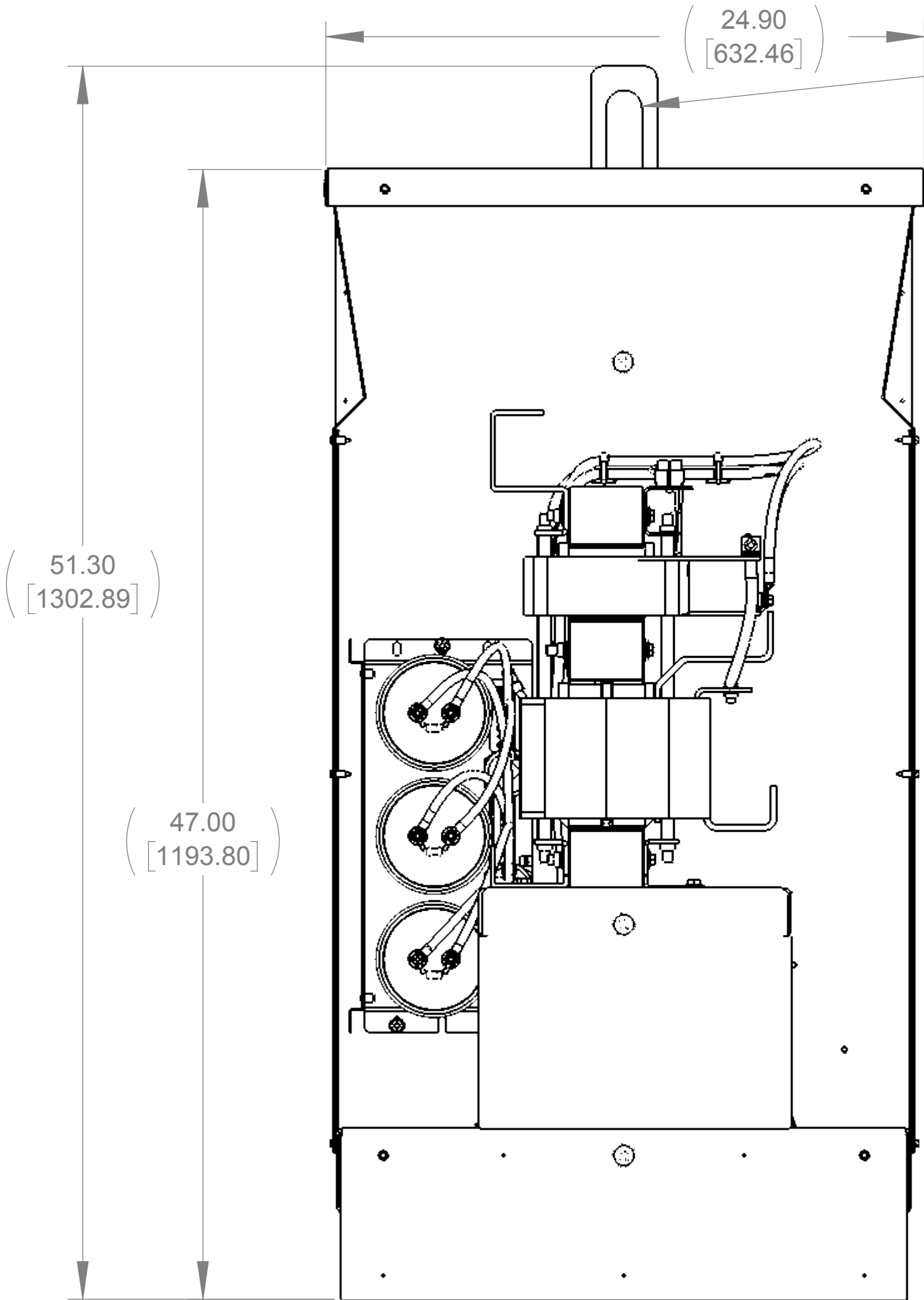

SIDE VIEW  
(PANELS REMOVED)

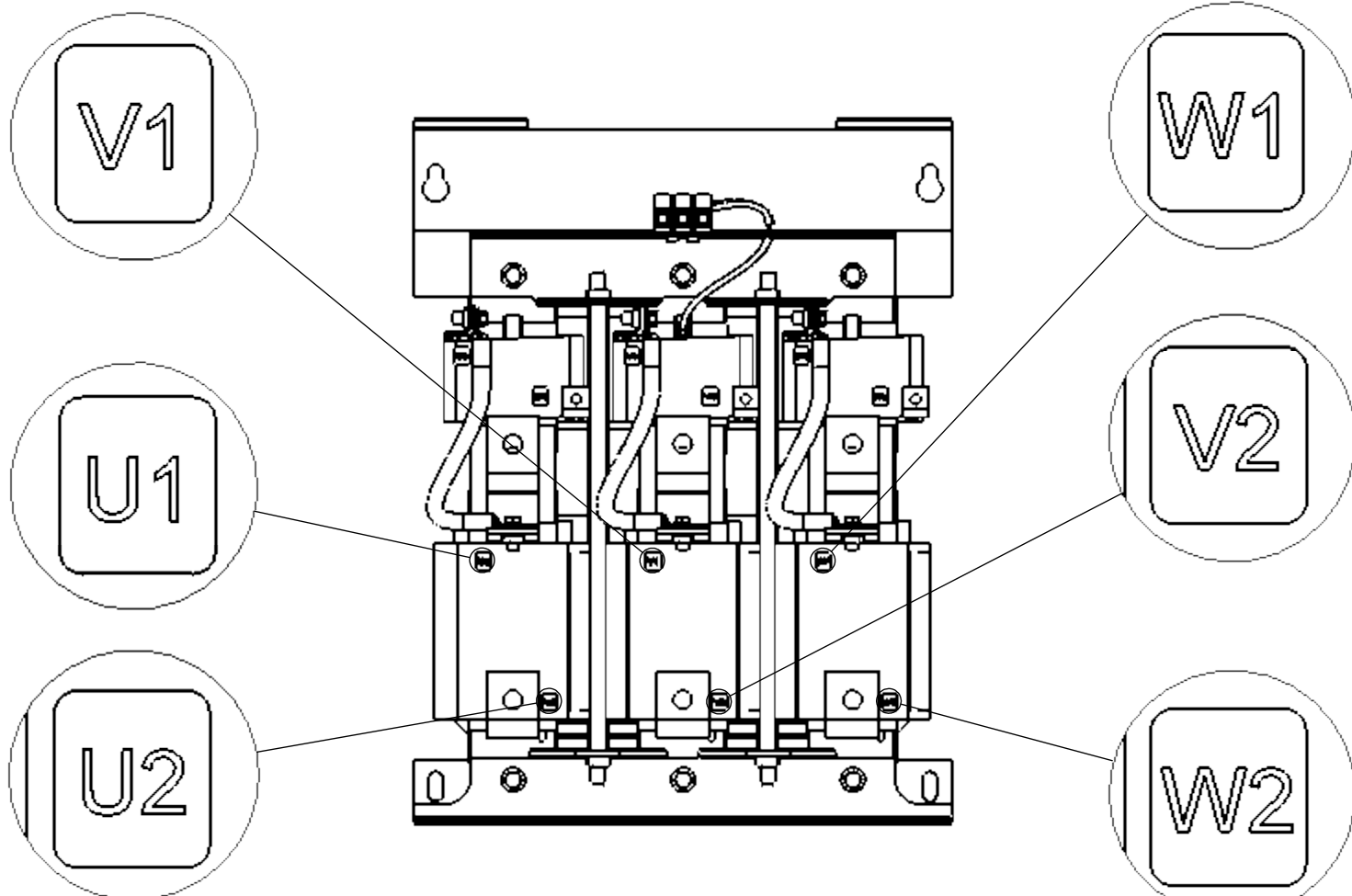
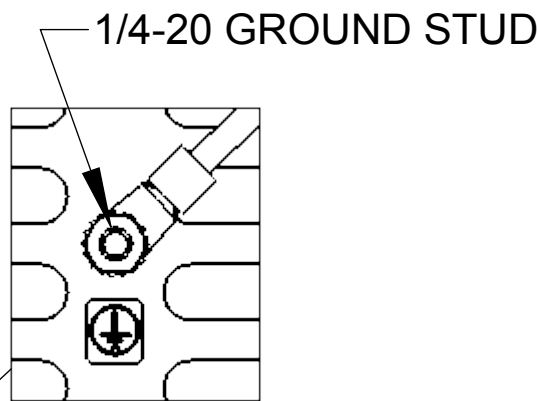

CUSTOMER CONNECTION  
DETAIL VIEW

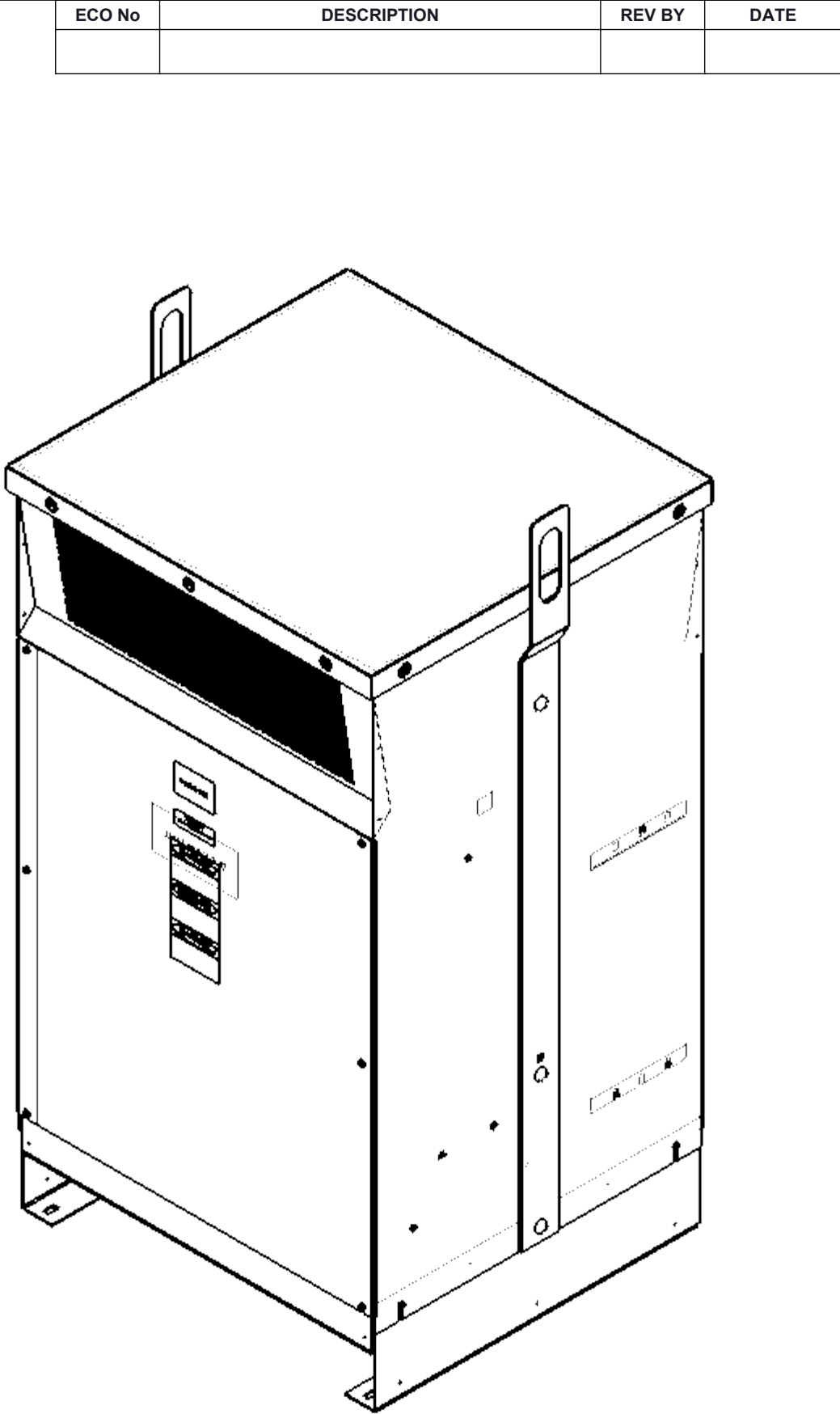

D

C

B

A

NOTES:

1. TERMINAL SCREW TIGHTENING TORQUE: 16 IN/LBS.
2. WIRE RANGE: 4-14 AWG.

THE COMPONENT, PART OR ASSEMBLY DESCRIBED IN THIS DOCUMENT MUST COMPLY WITH THE EU(EUROPEAN UNION) DIRECTIVE RoHS2		MATERIAL		CONFIDENTIAL AND PROPRIETARY INFORMATION THIS DOCUMENT CONTAINS CONFIDENTIAL AND PROPRIETARY INFORMATION OF MTE CORPORATION AND MAY NOT BE USED, COPIED OR DISCLOSED TO OTHERS EXCEPT WITH THE AUTHORIZED WRITTEN PERMISSION OF MTE CORPORATION			
CONTAINS <0.1% OF ANY SVHC BY WEIGHT PER REACH REGULATION				DESCRIPTION			
<div>UNLESS OTHERWISE SPECIFIED DIMENSIONS ARE IN INCHES [MM] TOLERANCES ARE:</div> <div>ANGLES: ± 1 °</div> <div>1 PLACE .X: ± .1 [2.5]</div> <div>2 PLACE .XX: ± .03 [0.76]</div> <div>3 PLACE .XXX: ± .010 [0.254]</div> <div><div><div>MTE</div><div>POWER QUALITY. SOLVED.</div></div><div>N83 W13330 Leon Road Menomonee Falls, WI 53051 USA 800.455-4683 262.253.8200</div></div>		DRAWN		DATE		MATRIX AP 240A 240V 60Hz FILTER, NEMA 1/2 ENCL	
		KV		09/04/18			
		CHECKED		DATE			
		KV		09/04/18			
		APPROVED		DATE		SIZE	
		AK		10/03/18		D	
						DWG No.	
						CD MAPG0240A	
						REV	
						00	
						SCALE 1:5	
						SHEET 1 OF 1	